

Guida alle referenze  
Guide to references

FR 1/4" 042 20 08 R TT SS

**Prodotto**  
Product

R = Regolatore  
Regulator  
F = Filtro  
Filter  
MF = Microfiltro  
Microfilter  
CF = Filtro a carboni attivi  
Carbon filter  
L = Lubrificatore  
Lubricator  
**FR** = Filtro regolatore  
Filter regulator  
V3 = Valvola a 3 vie  
Way on-off valve  
SV = Valvola di sezionamento  
Shut-off valve  
AVP = Avviatore progressivo  
Slow start valve

**Connessione**  
Connection

1/4" = G1/4"

**Linea**  
Line

042

**Elemento filtrante**  
Filtering element

5 = 5 micron  
**20** = 20 micron  
0,01 = 0,01 micron  
CA = carbon

**Tipo speciale**  
Special Type

VL = Caricamento in depressione  
Vacuum loading  
B = Batteria (solo per "R")  
Battery (only for "R")

**Scarico**  
Drain

**SS** = Manuale e semi-automatico (standard)  
Manual and semi-automatic (standard)  
SA = Automatico a galleggiante  
Automatic float type  
SAD = Automatico differenziale  
Automatic differential

**Tazza**  
Bowl

PE = Protezione esterna  
External protection  
**TT** = Trasparente  
Transparent  
TC = Trasparente corta  
Short transparent

**Versione**  
Version

**R** = Relieving (per aria)  
Relieving (for air)  
A = Senza relieving (per acqua)  
No relieving (for water)

**Campo di regolazione**  
Range of pressure

04 = 0+4 Bar  
**08** = 0+8 Bar  
12 = 0+12 Bar

**Regolatore**  
Regulator



| CODICE-CODE  | REF.            |
|--------------|-----------------|
| 042.01.00004 | R 1/4" 042 04 R |
| 042.01.00005 | R 1/4" 042 08 R |
| 042.01.00006 | R 1/4" 042 12 R |

**Lubrificatore**  
Lubricator



| CODICE-CODE  | REF.                                     |
|--------------|--|
| 042.03.00000 | L 1/4" 042 TT                            |
| 042.03.00072 | L 1/4" 042 PE                            |
| 042.03.00078 | L 1/4" 042 TC (tazza corta - short bowl) |
| 042.03.00500 | L 1/4" 042 TT VL                         |
| 042.03.00501 | L 1/4" 042 PE VL                         |

**Regolatore per batteria**  
Regulator for battery



| CODICE-CODE  | REF.              |
|--------------|-------------------|
| 042.01.00045 | R 1/4" 042 02 R B |
| 042.01.00046 | R 1/4" 042 04 R B |
| 042.01.00047 | R 1/4" 042 08 R B |
| 042.01.00048 | R 1/4" 042 12 R B |

**Filtro regolatore**  
Filter regulator



| CODICE-CODE  | REF.   |
|--|--|
| 042.04.00000                                       | FR 1/4" 042 20 08 R TT SS                          |
| 042.04.00052                                       | FR 1/4" 042 20 12 R TT SS                          |
| 042.04.00113                                       | FR 1/4" 042 5 08 R TT SS                           |
| 042.04.00114                                       | FR 1/4" 042 5 12 R TT SS                           |
| 042.04.00133                                       | FR 1/4" 042 20 08 R TC SS (tazza corta-short bowl) |
| 042.04.00230                                       | FR 1/4" 042 5 08 R TC SS (tazza corta-short bowl)  |
| 042.04.00072                                       | FR 1/4" 042 20 08 R PE SS                          |
| 042.04.00129                                       | FR 1/4" 042 5 08 R PE SS                           |
| <b>Versione Scarico Automatico a galleggiante</b>  |  |
| Float type automatic drain version                 |  |
| 042.04.00151                                       | FR 1/4" 042 20 08 R TT SA                          |
| 042.04.00154                                       | FR 1/4" 042 5 08 R TT SA                           |
| 042.04.00157                                       | FR 1/4" 042 20 08 R PE SA                          |
| 042.04.00160                                       | FR 1/4" 042 5 08 R PE SA                           |
| <b>Versione Scarico Automatico "Differenziale"</b> |  |
| "Differential" automatic drain version             |  |
| 042.04.00238                                       | FR 1/4" 042 20 08 R TT SAD                         |
| 042.04.00240                                       | FR 1/4" 042 5 08 R TT SAD                          |
| 042.04.00242                                       | FR 1/4" 042 20 08 R PE SAD                         |
| 042.04.00244                                       | FR 1/4" 042 5 08 R PE SAD                          |

**Filtro**  
Filter



| CODICE-CODE  | REF.   |
|--|--|
| 042.02.00000                                       | F 1/4" 042 20 TT SS                            |
| 042.02.00109                                       | F 1/4" 042 5 TT SS                             |
| 042.02.00072                                       | F 1/4" 042 20 PE SS                            |
| 042.02.00118                                       | F 1/4" 042 5 PE SS                             |
| 042.02.00110                                       | F 1/4" 042 20 TC SS (tazza corta - short bowl) |
| 042.02.00176                                       | F 1/4" 042 5 TC SS (tazza corta - short bowl)  |
| <b>Versione Scarico Automatico a galleggiante</b>  |  |
| Float type automatic drain version                 |  |
| 042.02.00151                                       | F 1/4" 042 20 TT SA                            |
| 042.02.00152                                       | F 1/4" 042 5 TT SA                             |
| 042.02.00153                                       | F 1/4" 042 20 PE SA                            |
| 042.02.00154                                       | F 1/4" 042 5 PE SA                             |
| <b>Versione Scarico Automatico "Differenziale"</b> |  |
| "Differential" automatic drain version             |  |
| 042.02.00180                                       | F 1/4" 042 20 TT SAD                           |
| 042.02.00181                                       | F 1/4" 042 5 TT SAD                            |
| 042.02.00182                                       | F 1/4" 042 20 PE SAD                           |
| 042.02.00183                                       | F 1/4" 042 5 PE SAD                            |

**Microfiltro antiolio a coalescenza**  
Coalescent oil-proof microfilter



| CODICE-CODE  | REF.  |
|--|---|
| 042.02.00064                                       | MF 1/4" 042 0.01 TT SS                            |
| 042.02.00115                                       | MF 1/4" 042 0.01 PE SS                            |
| 042.02.00111                                       | MF 1/4" 042 0.01 TC SS (tazza corta - short bowl) |
| <b>Versione Scarico Automatico a galleggiante</b>  |   |
| Float type automatic drain version                 |   |
| 042.02.00159                                       | MF 1/4" 042 0.01 TT SA                            |
| 042.02.00160                                       | MF 1/4" 042 0.01 PE SA                            |
| <b>Versione Scarico Automatico "Differenziale"</b> |   |
| "Differential" automatic drain version             |   |
| 042.02.00184                                       | MF 1/4" 042 0.01 TT SAD                           |
| 042.02.00185                                       | MF 1/4" 042 0.01 PE SAD                           |

**Filtro a Carboni attivi**  
Activated Carbon filter



| CODICE-CODE  | REF.  |
|--------------|---|
| 042.02.00300 | CF 041 1/4 CA TT                            |
| 042.02.00301 | CF 041 1/4 CA TC (tazza corta - short bowl) |
| 042.02.00302 | CF 041 1/4 CA PE                            |

Per altre esecuzioni contattare l'ufficio commerciale  
For further versions, please contact our sales dept.

→ = Standard version

Valvola d'intercettazione a 3 vie con blocco  
3 Way on-off valve



| CODICE-CODE  | REF.           |
|--------------|----------------|
| 042.25.00001 | V 1/4" 042 V 3 |

Valvola di sezionamento  
Shut-off valve

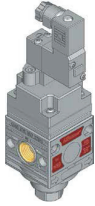

| CODICE-CODE  | REF.   |
|--------------|--|
| 042.26.00002 | SV 1/4" 042 Pred. C. Electr. Microsol/Pneum. |
| C50.26.00002 | Kit. C. Electr. 3/2 NC 2W 24V DC Microsol    |
| C50.26.00003 | Kit. C. Electr. 3/2 NC 1W 24V AC Microsol    |
| C50.26.00004 | Kit. C. Electr. 3/2 NC 1W 110V AC Microsol   |
| C50.26.00005 | Kit. C. Electr. 3/2 NC 1W 220V AC Microsol   |
| C40.26.00014 | Kit. C. Pneum.                               |

| CODICE-CODE  | REF.                               |
|--------------|------------------------------------|
| 042.26.00001 | SV 1/4" 042 Pred. C. Electr. Cnomo |
| C40.26.00011 | C. Electr. EV 3/2 NC Cnomo         |
| A50.26.00006 | Sol. 2.5W 24 DC                    |
| A50.26.00007 | Sol. 2.5W 24V AC                   |
| A50.26.00008 | Sol. 2.5W 110V AC                  |
| A50.26.00009 | Sol. 2.5W 220V AC                  |
| A50.26.00010 | Conn. Cnomo                        |

Avviatore progressivo  
Slow start valve

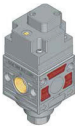

| CODICE-CODE  | REF.                   |
|--------------|------------------------|
| 042.27.00001 | AVP 1/4" 042 PN Autom. |

Gruppo F+R+L  
F+R+L Unit

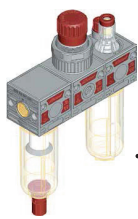

| CODICE-CODE  | REF.                            |
|--------------|---------------------------------|
| 042.05.****  | F+R+L 1/4" 042 20 08 R TT SS    |
| 042.05.00103 | F+R+L 1/4" 042 20 12 R TT SS    |
| 042.05.00105 | F+R+L 1/4" 042 5 08 R TT SS     |
| 042.05.00170 | F+R+L 1/4" 042 20 08 R TC SS    |
| 042.05.00172 | F+R+L 1/4" 042 5 08 R TC SS     |
| 042.05.00500 | F+R+L 1/4" 042 20 08 R TT SS VL |
| 042.05.00504 | F+R+L 1/4" 042 20 12 R TT SS VL |
| 042.05.00118 | F+R+L 1/4" 042 20 08 R PE SS    |
| 042.05.00114 | F+R+L 1/4" 042 20 12 R PE SS    |
| 042.05.00116 | F+R+L 1/4" 042 5 08 R PE SS     |
| 042.05.00117 | F+R+L 1/4" 042 5 12 R PE SS     |
| 042.05.00501 | F+R+L 1/4" 042 20 08 R PE SS    |

  

| Versione Scarico Automatico a galleggiante<br>Float type automatic drain version |                              |
|--|------------------------------|
| 042.05.00151   | F+R+L 1/4" 042 20 08 R TT SA |
| 042.05.00157   | F+R+L 1/4" 042 20 08 R PE SA |

| Versione Scarico Automatico "Differenziale"<br>"Differential" automatic drain version |                               |
|---|-------------------------------|
| 042.05.00166  | F+R+L 1/4" 042 20 08 R TT SAD |
| 042.05.00168  | F+R+L 1/4" 042 20 08 R PE SAD |

Gruppo FR+L  
FR+L Unit

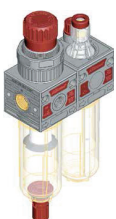

| CODICE-CODE  | REF.                           |
|--------------|--------------------------------|
| 042.06.****  | FR+L 1/4" 042 20 08 R TT SS    |
| 042.06.00052 | FR+L 1/4" 042 20 12 R TT SS    |
| 042.06.00115 | FR+L 1/4" 042 5 08 R TT SS     |
| 042.06.00116 | FR+L 1/4" 042 5 12 R TT SS     |
| 042.06.00124 | FR+L 1/4" 042 20 08 R TC SS    |
| 042.06.00132 | FR+L 1/4" 042 20 12 R TC SS    |
| 042.06.00133 | FR+L 1/4" 042 5 08 R TC SS     |
| 042.06.00134 | FR+L 1/4" 042 5 12 R TC SS     |
| 042.06.00500 | FR+L 1/4" 042 20 08 R TT SS VL |
| 042.06.00504 | FR+L 1/4" 042 20 12 R TT SS VL |

| CODICE-CODE  | REF.                           |
|--------------|--------------------------------|
| 042.06.00072 | FR+L 1/4" 042 20 08 R PE SS    |
| 042.06.00126 | FR+L 1/4" 042 20 12 R PE SS    |
| 042.06.00128 | FR+L 1/4" 042 5 08 R PE SS     |
| 042.06.00129 | FR+L 1/4" 042 5 12 R PE SS     |
| 042.06.00501 | FR+L 1/4" 042 20 08 R PE SS VL |
| 042.06.00505 | FR+L 1/4" 042 20 12 R PE SS VL |

Gruppo V3+FR+L  
V3+FR+L Unit

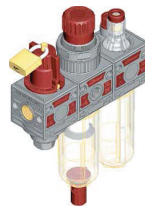

| CODICE-CODE  | REF.                              |
|--------------|-----------------------------------|
| 042.36.****  | V3+FR+L 1/4" 042 20 08 R TT SS    |
| 042.36.00115 | V3+FR+L 1/4" 042 5 08 R TT SS     |
| 042.36.00130 | V3+FR+L 1/4" 042 20 08 R TC SS    |
| 042.36.00132 | V3+FR+L 1/4" 042 5 08 R TC SS     |
| 042.36.00500 | V3+FR+L 1/4" 042 20 08 R TT SS VL |
| 042.36.00072 | V3+FR+L 1/4" 042 20 08 R PE SS    |
| 042.36.00126 | V3+FR+L 1/4" 042 20 12 R PE SS    |
| 042.36.00128 | V3+FR+L 1/4" 042 5 08 R PE SS     |
| 042.36.00501 | V3+FR+L 1/4" 042 20 08 R PE SS VL |

  

| Versione Scarico Automatico a galleggiante<br>Float type automatic drain version |                                |
|--|--------------------------------|
| 042.36.00151   | V3+FR+L 1/4" 042 20 08 R TT SA |
| 042.36.00153   | V3+FR+L 1/4" 042 20 12 R TT SA |
| 042.36.00157   | V3+FR+L 1/4" 042 20 08 R PE SA |

| Versione Scarico Automatico "Differenziale"<br>"Differential" automatic drain version |                                 |
|---|---------------------------------|
| 042.36.00191  | V3+FR+L 1/4" 042 20 08 R TT SAD |
| 042.36.00193  | V3+FR+L 1/4" 042 20 08 R PE SAD |

Gruppo F+L  
F+L Unit

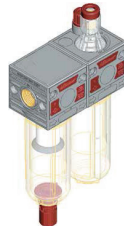

| CODICE-CODE  | REF.                     |
|--------------|--------------------------|
| 042.07.****  | F+L 1/4" 042 20 TT SS    |
| 042.07.00132 | F+L 1/4" 042 20 TC SS    |
| 042.07.00500 | F+L 1/4" 042 20 TT SS VL |
| 042.07.00072 | F+L 1/4" 042 20 PE SS    |
| 042.07.00501 | F+L 1/4" 042 20 PE SS VL |

  

| Versione Scarico Automatico a galleggiante<br>Float type automatic drain version |                          |
|--|--------------------------|
| 042.07.00151   | F+L 1/4" 042 20 TT SA    |
| 042.07.00153   | F+L 1/4" 042 20 PE SA    |
| 042.07.00513   | F+L 1/4" 042 20 PE SA VL |

| Versione Scarico Automatico "Differenziale"<br>"Differential" automatic drain version |                        |
|---|------------------------|
| 042.07.00128  | F+L 1/4" 042 20 TT SAD |
| 042.07.00129  | F+L 1/4" 042 5 TT SAD  |
| 042.07.00130  | F+L 1/4" 042 20 PE SAD |
| 042.07.00131  | F+L 1/4" 042 5 PE SAD  |

Gruppo F+MF  
F+MF Unit

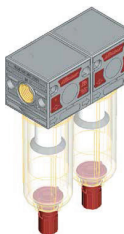

| CODICE-CODE  | REF.                                  |
|--------------|---------------------------------------|
| 042.09.00001 | F 1/4" 042 5 TT SS+MF 1/4" 0,01 TT SS |
| 042.09.00003 | F 1/4" 042 5 PE SS+MF 1/4" 0,01 PE SS |
| 042.09.00005 | F 1/4" 042 5 TC SS+MF 1/4" 0,01 TC SS |

| Versione Scarico Automatico a galleggiante<br>Float type automatic drain version |                                       |
|--|---------------------------------------|
| 042.09.00002   | F 1/4" 042 5 TT SS+MF 1/4" 0,01 TT SA |
| 042.09.00004   | F 1/4" 042 5 PE SS+MF 1/4" 0,01 PE SA |

| Versione Scarico Automatico "Differenziale"<br>"Differential" automatic drain version |  |
|---|--|
| 042.09.00005  | F 1/4" 042 5 TT SS+MF 1/4" 0,01 TT SAD |
| 042.09.00006  | F 1/4" 042 5 PE SS+MF 1/4" 0,01 PE SAD |

Gruppo F+MF+CF  
F+MF+CF Unit



| CODICE-CODE  | REF.                                 |
|--------------|--------------------------------------|
| 042.08.00001 | F 5 TT SS+MF 0,01 TTSS+CF TT 1/4 042 |
| 042.08.00002 | F 5 TT SS+MF 0,01 TTSA+CF TT 1/4 042 |
| 042.08.00003 | F 5 TT SS+MF 0,01 PESS+CF PE 1/4 042 |
| 042.08.00004 | F 5 TT SS+MF 0,01 PESA+CF PE 1/4 042 |

→ = Standard version